

Daily Rate: Tuesday-Friday
Weekend Rate: Saturday-Tuesday



FISHING

Lake/River

Rod & Reel Trout	Rate: \$10/day	\$20/wknd
Rod & Reel Fly	Rate: \$10/day	\$20/wknd
R&R Salmon/Halibut	Rate: \$15/day	\$30/wknd
Landing Net	Rate: \$3/day	\$6/wknd
Salmon Dipnets	Rate: \$15/day	\$30/wknd
Waders	Rate: \$30/day	\$60/wknd

It is the customers responsibility to obtain a fishing license. Please refer to <https://www.adfg.alaska.gov>

PADDLE BOARDS



Paddle Boards Yolo	Rate: \$35/day	\$70/wknd
Paddle Boards Bote	Rate: \$35/day	\$70/wknd

CAMPINGSUPPLIES

4 Person Tent	Rate: \$15/day	\$30/wknd
Sleeping Bag	Rate: \$5/day	\$10/wknd
Cot	Rate: \$5/day	\$10/wknd
Ice Chest Cooler	Rate: \$10/day	\$20/wknd
BuddyHeater (Propane)	Rate: \$5/day	\$20/wknd
Camping Grill (Propane)	Rate: \$10/day	\$20/wknd
Gold Pans	Rate: \$3/day	\$6/wknd



BOATS

Boat Motor 2.3/9.9HP	Rate: \$15	\$30/wknd
Kayak (1 Person)	Rate: \$25	\$50/wknd
Kayak (2 Person)16'	Rate: \$30	\$60/wknd
Canoe (2 Person)16'	Rate: \$30	\$60/wknd
Jon Boat with9.9	Rate: \$30	\$60/wknd
90 HP Jet / PontoonBoat	Rate: \$150	\$300/wknd
Canoe/Kayak Trailer	Rate: \$40	\$80/wknd
Single CanoeTrailer	Rate: \$15	\$30/wknd
Life Jackets	Rate: \$5	\$10/wknd

Certification: All Motorboat rentals require customers to complete a Boater Safety Course and show a certification card which can be completed at boat.us.org Boat licenses are accepted also.

Daily Rate: Tuesday-Friday
Weekend Rate: Saturday-Tuesday

PARTY SUPPLIES

Sumo Suits	\$50/day	\$100/wknd
Party Canopy 10x10	\$10/day	\$20/wknd
10x20 Event Tent	\$55/day	\$110/wknd
Tables 5/6/8 ft	\$6/day	\$12/wknd
Chairs	\$1/day	\$2/wknd
Jenga	\$10/day	\$20/wknd
Ladder Ball	\$5/day	\$10/wknd



Bounce Houses

8'H 10'X10' DRY Rate: \$90/day \$180/wknd	12'H 15'X15'Dry Palm Tree Rate: \$90/day \$180/wknd	15'H 23'X15' Dry Dual Dalmatian Rate: \$90/day \$180/wknd
14'H 28'X14' Duel Wet/ Dry EZ Sports Rate: \$100/Day \$200/wknd	10'H 20'X20' Dry Jumbo Castle Rate: \$100/Day \$200/wknd	8'H 25'X25' Dry Hippo Tug Rate: \$175/day \$350/wknd
13'H 38'X10' Obstacle Course Rate: \$175/day \$350/wknd	22'H 36'X13' Wet/Dry Slide Rate: \$175/Day \$350/wknd Add-on 19'L Slip'n'Slide \$75/Day	14'H 22'X12' Carnival Game Rate: \$175/day \$350/wknd

BRING HELP TO LOAD/UNLOAD BOUNCE HOUSES,
ODR Staff is not responsible for your rental Pick-up/Drop-off

Outdoor Recreation Rental Policies

Rental Period: All rentals are based on a calendar day, and due back by 1 HOUR BEFORE the close of business on the due date. Rental charges begin the day the equipment is pickedup. **Reservation Policy:** Full payment is required for all reservations to be held. Payment can be made over the phone by a credit card or in person. **Reservation Refund Policy:** If the reservation is canceled 4 days before scheduled pickup, a refund of 100%, 3 days before 75%, 2 days before 50%, 1 day before 25%, and canceling the day of pickup results in **no refund.** **Early Returns:** No refund will be given for returning equipment early. **Late Returns:** The charge for equipment returned late are additional daily fees. **Propane:** Is the responsibility of the renter. **Gasoline:** All equipment that requires gasoline must be returned full.

Certification:
All Boat motor rentals require a Boat License or Boater Safety Course Certificate. All ATV/SxS/Snowmobile rentals require a Rider Safety Course Certificate. All Travel Trailer rentals require a Travel Trailer Safety Course Certificate.



(907) 873-4058 OR
(907) 873-3292



DAYS & HOURS OF OPERATION

Tuesday-Thursday-Friday-Saturday

Hours - 10:00-18:00

Closed on most Holidays

CLOSED Sunday, Monday, Wednesday



Outdoor Recreation

Fort Greely DFMWR
U.S. Army Garrison Fort Greely Alaska

Arctic Ave., Bldg 627
Usag Fort Greely, Alaska 99731

Daily Rate: Tuesday-Friday
Weekend Rate: Saturday-Tuesday

Trailers

(Tow Ball \$10 rent fee)

Cargo Enclosed Trailers

Trailer 4'X6'

Rate: \$25/day \$50/wknd
Max Weight: 1,340 lb's
*Requires 2" Ball



Trailer 6'X12'

Rate: \$50/day \$100/wknd
Max Weight: 1,700 lb's
*Requires 2" Ball



Trailer 8'X15'

Rate: \$60/day \$120/wknd
Max Weight: 5,143 lb's
*Requires 2-5/16" Ball



Long Vnose 26'

Rate: \$80/day \$160/wknd
Max Weight: 5,062 lb's
*Requires 2-5/16" Ball



Deckover Trailers – 2' Tow Ball

2 Place Tilt Tr. 8'

Rate: \$45/day \$90/wknd
Max Weight: 1,775 lb's



2 Place Tr. 12'

Rate: \$50/day \$100/wknd
Max Weight: 2,400 lb's



4 Place Tr. 22'

Rate: \$60/day \$120/wknd
Max Weight: 4,800 lb's



Equipment/Car/Truck Hauler 18'

(With NO Winch)

Rate: \$65/day \$130/wknd
*2 5/16" Tow Ball



Weight Max: 14,000 lbs

Weight Max: 9,266 lbs

Daily Rate: Tuesday-Friday
Weekend Rate: Saturday-Tuesday

Please check with your local insurance company to be sure you are covered when renting ODR equipment. It is the renters full responsibility to pay for any/all damages that may occur.

“REFER TO YOUR VEHICLES OWNER'S MANUAL FOR TOWING CAPACITY”

Travel Trailers

20' Prowler Lynx (Tow Hitch included)

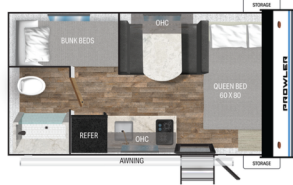

1 Queen & Bunk Bed

Military Rate: \$145/day \$290/wknd
Civilian Rate: \$175/day \$350/wknd
Weight 3,862 lbs. 4-6 person



1 Queen Bed

Military Rate: \$145/day \$290/wknd
Civilian Rate: \$175/day \$350/wknd
Weight 3,902 lbs. 2-4 person

Generator

1000 Rate: \$30/day \$60/wknd
2200i Rate: \$40/day \$80/wknd



ATV Meat Wagon

Rate: \$40/day \$80/wknd
(requires 1 7/8" ball)



The renter is responsible for the item/s rented. If the renter has their certification for an ATV, Side X Side, Travel Trailer or Boat, the renter is to be the ONLY OPERATOR. No one else is authorized to operate the rented item under any circumstances. Thank You.

Daily Rate: Tuesday-Friday
Weekend Rate: Saturday-Tuesday

BYCYCLES

Mountain Bikes/with Helmets Rate: \$10/day \$20/wknd



ATV's

Yamaha 450 Grizzly Polaris 800



Military Rate: \$90/day \$180/wknd
Civilian Rate: \$105/day \$210/wknd

Honda Rubicon 500 Can-am 570



Military Rate: \$100/day \$200/wknd
Civilian Rate: \$135/day \$270/wknd

Can-Am 800



Military Rate: \$185/day \$370/wknd
Civilian Rate: \$200/day \$400/wknd
1,931 lbs. Seats 3 people

Can-Am 1000



Military Rate: \$220/day \$440/wknd
Civilian Rate: \$235/day \$470/wknd
2,337 lbs. Seats 6 people

ATV/BIKE ACCESSORIES

Helmets Rate: \$5/day \$10/wknd



You need to have your ATV and/or Side X Side Rider Course Certification Card complete and present, in order to rent one of our ATV's or Side X Sides.

Prior to the ATV class you MUST do the E-course at atvsafety.org & rohva.org for the SxS Class

ATV/SxS classes are available during the summer on certain days of the week at Outdoor Recreation.

To sign-up please CALL (907)873-4058 or (907)873-3292.

It would be in your best interest to call your insurance company to make sure you are covered in case any person or ODR property is hurt or damaged.